



EI-1/4-135
EI-1/4-150
EI-1/4-180
EI-1/4-200
EI-1/4-225
EI-1/4-250

EI-1/3-135
EI-1/3-150
EI-1/3-180
EI-1/3-200
EI-1/3-225
EI-1/3-250

EI-1/4-135-T
EI-1/4-150-T
EI-1/4-180-T
EI-1/4-200-T
EI-1/4-225-T
EI-1/4-250-T

EI-1/3-135-T
EI-1/3-150-T
EI-1/3-180-T
EI-1/3-200-T
EI-1/3-225-T
EI-1/3-250-T

Cubetas GN NO incluidas en el precio, ver página 442
GN containers NOT included in price, see page 442

FAST & COOL FOOD

mod.	rango range °C	largo length (mm)	fondo depth (mm)	capacidad capacity 1/4	capacidad capacity 1/6	voltaje voltage	refrigerante refrigerant		potencia frig. frig. power W		potencia power W	
							R134a	R290	EI-T	EI		
EI-1/4-135	+2°C +8°C	1345	336	2	2	230V-50Hz	R134a	140	149	170	152	
							R290	158	131	152		
EI-1/4-150	+2°C +8°C	1495	336	3	3	230V-50Hz	R134a	140	149	170	155	
							R290	170	134	155		
EI-1/4-180	+2°C +8°C	1795	336	4	4	230V-50Hz	R134a	140	156	182	162	
							R290	190	136	162		
EI-1/4-200	+2°C +8°C	2020	336	5	5	230V-50Hz	R134a	178	180	222	180	
							R290	200	138	180		
EI-1/4-225	+2°C +8°C	2245	336	1	1	230V-50Hz	R124a	178	184	226	182	
							R290	210	140	182		
EI-1/4-250	+2°C +8°C	2545	336	1	1	230V-50Hz	R134a	178	186	228	185	
							R290	225	143	185		
EI-1/3-135	+2°C +8°C	1345	396	1	1	230V-50Hz	R134a	140	149	170	152	
							R290	158	131	152		
EI-1/3-150	+2°C +8°C	1495	396	0	0	230V-50Hz	R124a	140	149	170	155	
							R290	170	134	155		
EI-1/3-180	+2°C +8°C	1795	396	0	0	230V-50Hz	R134a	140	156	182	162	
							R290	190	136	162		
EI-1/3-200	+2°C +8°C	2020	396	0	0	230V-50Hz	R134a	178	180	222	180	
							R290	200	138	180		
EI-1/3-225	+2°C +8°C	2245	396	0	0	230V-50Hz	R124a	178	184	226	182	
							R290	210	140	182		
EI-1/3-250	+2°C +8°C	2545	396	0	0	230V-50Hz	R134a	178	186	228	185	
							R290	225	143	185		

*opcional - optional

Características técnicas y constructivas sujetas a variación sin previo aviso.

We reserve the right to change specifications without prior notice.

- EI cúpula de cristal
- EI-T cubierta inox abatible

- EI glass cover options
- EI-T hinged stainless steel cover

- Exterior e interior en acero inox AISI-304
- Capacidad para cubetas GN no incluidas
- Apoyos regulables en altura
- Evaporador por placa fría
- Aislamiento de poliuretano inyectado, densidad 40 Kg/m³, cero efectos ODP y GWP
- Control digital de temperatura, alarma por alta temperatura de condensación. Eficiente gestión del consumo de energía
- Temperatura de trabajo a 32°C ambiente

- AISI-304 stainless steel exterior and interior
- GN containers capacity, not included
- Adjustable supports
- Cold plate evaporator
- 40 Kg/m³ density polyurethane insulation, zero ODP and GWP
- Digital temperature control, high-temperature condensation alarm. Efficient management of energy consumption
- Operating temperature, 32°C ambient

OPCIONES	OPTIONS	€
cambio R134a por R290	R134a to R290	
230v 60Hz / 115v 60Hz	230v 60Hz / 115v 60Hz	

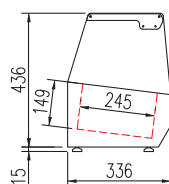

EI-1/4

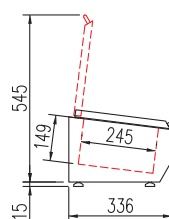

EI-1/4-T

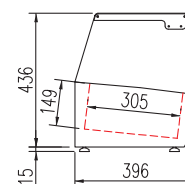

EI-1/3

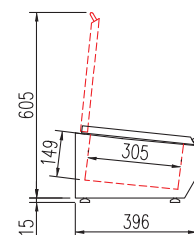

EI-1/3-T

all photos must be considered as a reference - fotografías no contractuales

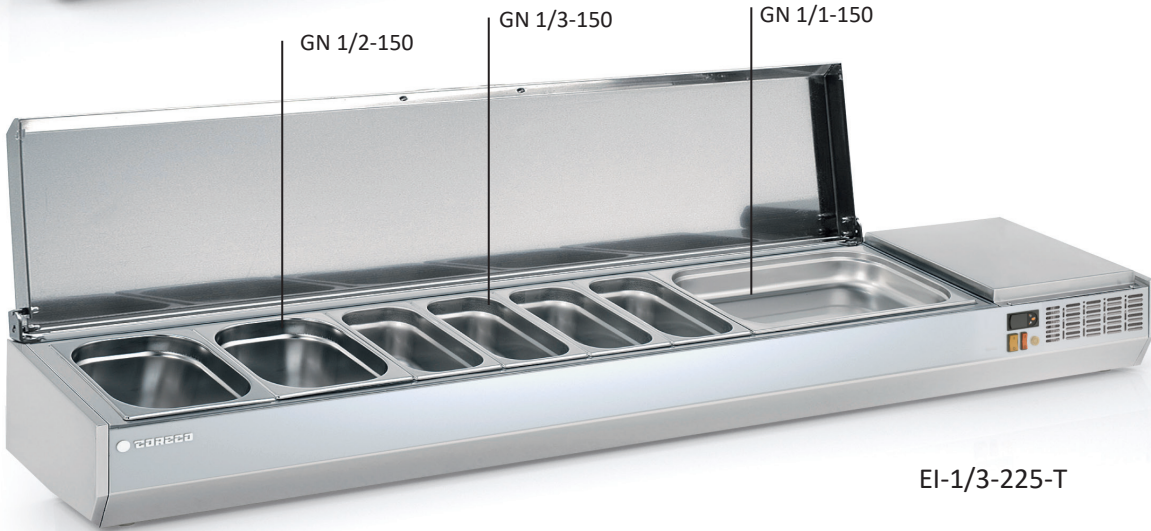
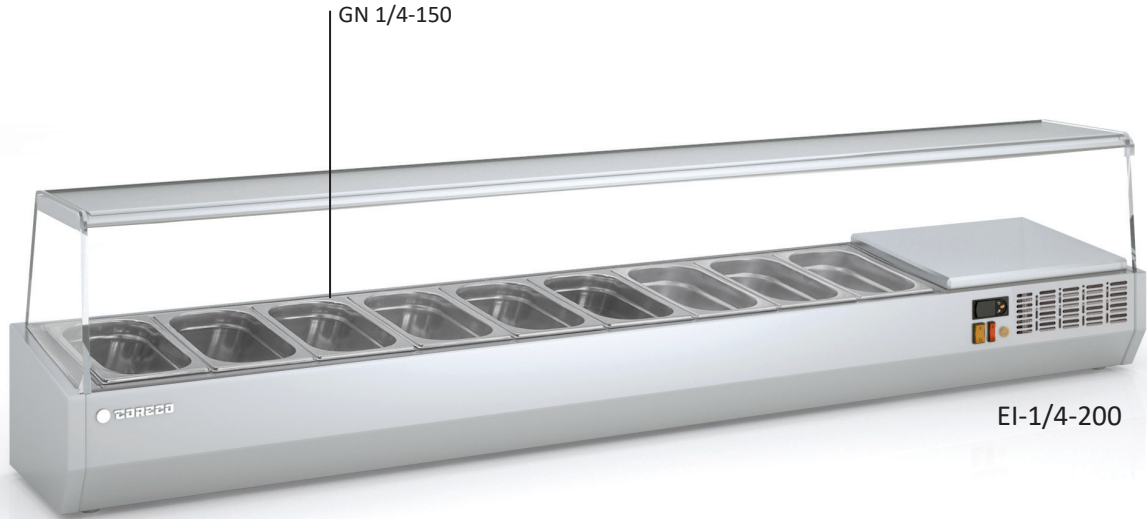

Luz de serie (EI)
Light as standard (EI)

EI-1/4-135
5xGN1/4



EI-1/4-150
6xGN1/4



EI-1/4-180
8xGN1/4



EI-1/4-200
9xGN1/4



EI1/4-225
10xGN1/4



EI-1/4-250
12xGN1/4



EI-1/3-135
5xGN1/3



EI-1/3-150
5xGN1/3



EI-1/3-180
7xGN1/3



EI-1/3-200
8xGN1/3



EI-1/3-225
10xGN1/3



EI-1/3-250
11xGN1/3

