



MCC-50-C



MCC-50-T



MCC-90



MCC-140

mod.	largo length (mm)	alto height (mm)	fondo depth (mm)	cajones drawers	tolva hopper	puertas doors
MCC-50-T	475	1040	600	0	1	1
MCC-50-C	475	1040	600	2	0	1
MCC-90	915	1040	600	2	1	2
MCC-140	1375	1040	600	4	1	2

Características técnicas y constructivas sujetas a variación sin previo aviso.

- Módulos de diseño compacto
 - Exterior y estantes en acero inox AISI-304, excepto el respaldo
 - Respaldo en acero plastificado
 - Encimera de acero inox AISI-304 con frente curvo y peto trasero sanitario de 100 mm (Opcional sin peto)
 - Cajones con guías de rodamientos
 - Cajón tolva para café, desmontable
 - Cajones y tolva, son intercambiables
 - Pies en tubo de acero inox ajustables en altura 135 - 210 mm
- Pueden fabricarse, bajo pedido, en diferentes medidas

MC-50-T: 1 x cajón tolva para café
MC-50-C: 2 x cajones con guías

We reserve the right to change specifications without prior notice.

- Compact designed modules
 - AISI-304 stainless steel exterior and shelf, except the rear side
 - Rear panel in plasticized steel
 - AISI-30418/10 stainless steel worktop, with rounded front and 100 mm sanitary upstand (optional without upstand)
 - Drawers with slides
 - Detachable coffee sediment special drawer with hitting surface
 - Interchangeable drawers (auxiliary and coffee)
 - AISI -304 adjustable legs, 135 to 210 mm
- Can be produced on request, in different measures

MC-50-T: 1 x coffe-grounds special drawer
MC-50-C: 2 x drawers with slides

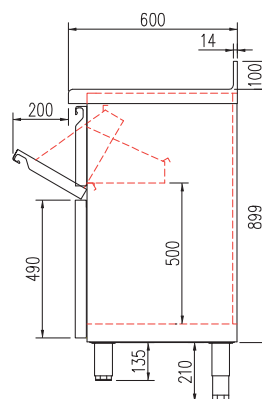
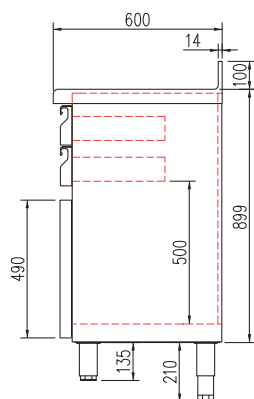

Forma línea con mesas frías gama FMR y FMRV, pag. 30- 35 • Match with refrigerated counters FMR and FMRV pag. 30-35

all photos must be considered as a reference - fotografías no contractuales



MCC-50-T



MCC-90



FMR-150 + MCC-50T
Encimera especial
Special worktop



MCC-140