

| Nº | DESCRIPCIÓN                         | DESCRIPTION                        | UPR-55     | UPL-55     |
|----|-------------------------------------|------------------------------------|------------|------------|
| 1  | RUEDA SIN FRENO 80Ø                 | WITHOUT BRAKE CASTOR 80Ø           | 6033130002 | 6033130002 |
|    | RUEDA CON FRENO 80Ø                 | WITH BRAKE CASTOR 80Ø              | 6033130001 | 6033130001 |
| 2  | DESAGUE 3/4                         | DRAIN PIPE 3/4                     | 6003010326 | 6003010326 |
| 3  | TAPÓN DESAGUE 3/4                   | DRAIN CAP 3/4                      | 6003010262 | 6003010262 |
| 4  | RESISTENCIA MARCO                   | FRAME FRONT RESISTANCE             | X          | 6021250007 |
| 5  | RESISTENCIA FRONTI VERTICAL         | VERTICAL FRONT RESISTANCE          | X          | 6021250010 |
| 6  | SOPORTE BISAGRA INFERIOR IZQUIERDO  | LEFT LOWER HINGE SUPPORT           | 6033010098 | 6033010098 |
| 7  | SOPORTE BISAGRA SUPERIOR IZQUIERDO  | LEFT UPPER HINGE SUPPORT           | 6033010110 | 6033010110 |
| 8  | EJE PUERTA                          | DOOR SHAFT                         | 6033090064 | 6033090064 |
| 9  | SOPORTE BISAGRA SUPERIOR DERECHO    | RIGHT UPPER HINGE SUPPORT          | 6033010109 | 6033010109 |
| 10 | SOPORTE BISAGRA INFERIOR DERECHO    | RIGHT LOWER HINGE SUPPORT          | 6033010099 | 6033010099 |
| 11 | MICRORRUPTOR CONMUTADO              | COMMUTATOR SWITCH                  | 6021130047 | 6021130047 |
| 12 | TERMOSTATO                          | THERMOSTAT                         | 6021350106 | 6021350096 |
|    | SONDA                               | PROBE                              | 6021350083 | 6021350083 |
| 13 | CABEZA CUADRO DE MANDOS             | CONTROL PANEL                      | A109010606 | A109010606 |
|    | CABEZA CUADRO DE MANDOS UPR/UPL-55G | CONTROL PANEL UPR/UPL-55G          | A109170485 | A109170485 |
| 14 | PASACABLES                          | CABLE GROMMETS                     | 6003010013 | 6003010013 |
| 15 | TAPA CABEZA                         | COVER PANEL                        | A109170442 | A109170442 |
| 16 | CONDENSADOR                         | CONDENSER                          | 6029020002 | 6029020110 |
| 17 | BANDEJA EVAP. AUTOM.                | AUTOMATIC EVAP. TRAY               | 6003010023 | 6003010023 |
| 18 | TUBERÍA EVAPORACIÓN AUTOMÁTICA      | AUTOMATIC EVAP. PIPE               | M107010037 | A107010073 |
| 19 | COMPRESOR                           | COMPRESSOR                         | 6021010236 | 6021010218 |
| 20 | VENTILADOR CONDENSADOR              | CONDENSER FAN                      | 6021050106 | 6021050126 |
|    | ASPA VENT. CONDENSADOR              | CONDENSER FAN BLADE                | 6021050080 | 6021050094 |
| 21 | TRANSFORMADOR LUZ LEDS              | LEDS LIGHT TRANSFORMER             | 6021290109 | 6021290109 |
|    | TRANSFORMADOR LUZ LEDS UPR/UPL-55G  | LEDS LIGHT TRANSFORMER UPR/UPL-55G | 6021290112 | 6021290112 |
| 22 | LUZ LEDS                            | LEDS LIGHT                         | 6021290120 | 6021290120 |
|    | LUZ LEDS UPR/UPL-55G                | LEDS LIGHT UPR/UPL-55G             | 6021290127 | 6021290127 |
| 23 | TAPA TUBOS RESPALDO                 | REAR COVER PIPE                    | A109170504 | A109170504 |
| 24 | REJILLA DE PROTECCIÓN               | PROTECTION GRILLE                  | A109170513 | A109170513 |
| 25 | RESISTENCIA EVAPORADOR              | EVAPORATOR RESISTANCE              | X          | 6021250109 |
| 26 | EVAPORADOR                          | EVAPORATOR                         | 6029010209 | 6029010216 |
| 27 | VENTILADOR EVAPORADOR               | EVAPORATOR FAN                     | 6021050107 | 6021050116 |
|    | ASPA VENT. EVAPORADOR               | EVAPORATOR FAN BLADE               | 6021050102 | 6021050073 |
| 28 | REJILLA VENTILADOR                  | FAN GRILLE EVAPORATOR              | 6003010493 | 6003010475 |
| 29 | RESISTENCIA DESAGUE                 | DRAIN RESISTANCE EVAPORATOR        | X          | 6021250006 |
| 30 | DESAGÜE CANALIZADOR                 | DRAIN CANAL                        | 6003010184 | 6003010192 |
| 31 | CREMALLERA                          | SHELF RACK                         | 6033210016 | 6033210016 |
| 32 | SOPORTE ESTANTE                     | SHELF HOLDER                       | 6033210019 | 6033210019 |
| 33 | PARRILLA                            | SHELF                              | 6027010141 | 6027010141 |
| 34 | PARRILLA INTERMEDIA                 | INTERMEDIATE SHELF                 | 6027010142 | 6027010142 |
| 35 | REJILLA MOTOR                       | MOTOR GRILLE                       | A109010596 | A109010596 |
|    | REJILLA MOTOR UPL-55G               | MOTOR GRILLE UPL-55G               | X          | A109010624 |
| 36 | BISAGRA DE TORSIÓN                  | TORSION HINGE                      | 6033010100 | 6033010100 |
| 37 | PUERTA CIEGA GRANDE                 | BIG DOOR                           | A169010133 | A169010133 |
| 38 | CAJA ALOJAMIENTO MUELLE             | HINGE PIN SUPPORT                  | 6003010136 | 6003010136 |
| 39 | BURLETE PUERTA CIEGA GRANDE         | BIG DOOR GASKET                    | 6045010239 | 6045010239 |
| 40 | TIRADOR PUERTA DE CRISTAL           | GLASS DOOR HANDLE                  | 6033010148 | 6033010148 |
| 41 | PUERTA CRISTAL GRANDE               | BIG GLASS DOOR                     | A169050055 | A169050059 |
| 42 | BURLETE PUERTA CRISTAL GRANDE       | BIG GLASS DOOR GASKET              | 6045010242 | 6045010242 |
| 43 | INTERRUPTOR LUZ UPR/UPL-55G         | LIGHT MAIN SWITCH UPR/UPL-55G      | 6021130051 | 6021130051 |
| 44 | INTERRUPTOR GENERAL                 | MAIN SWITCH ON/OFF                 | 6021130020 | 6021130020 |
| 45 | CERRADURA                           | LOCK                               | 6033010132 | 6033010132 |

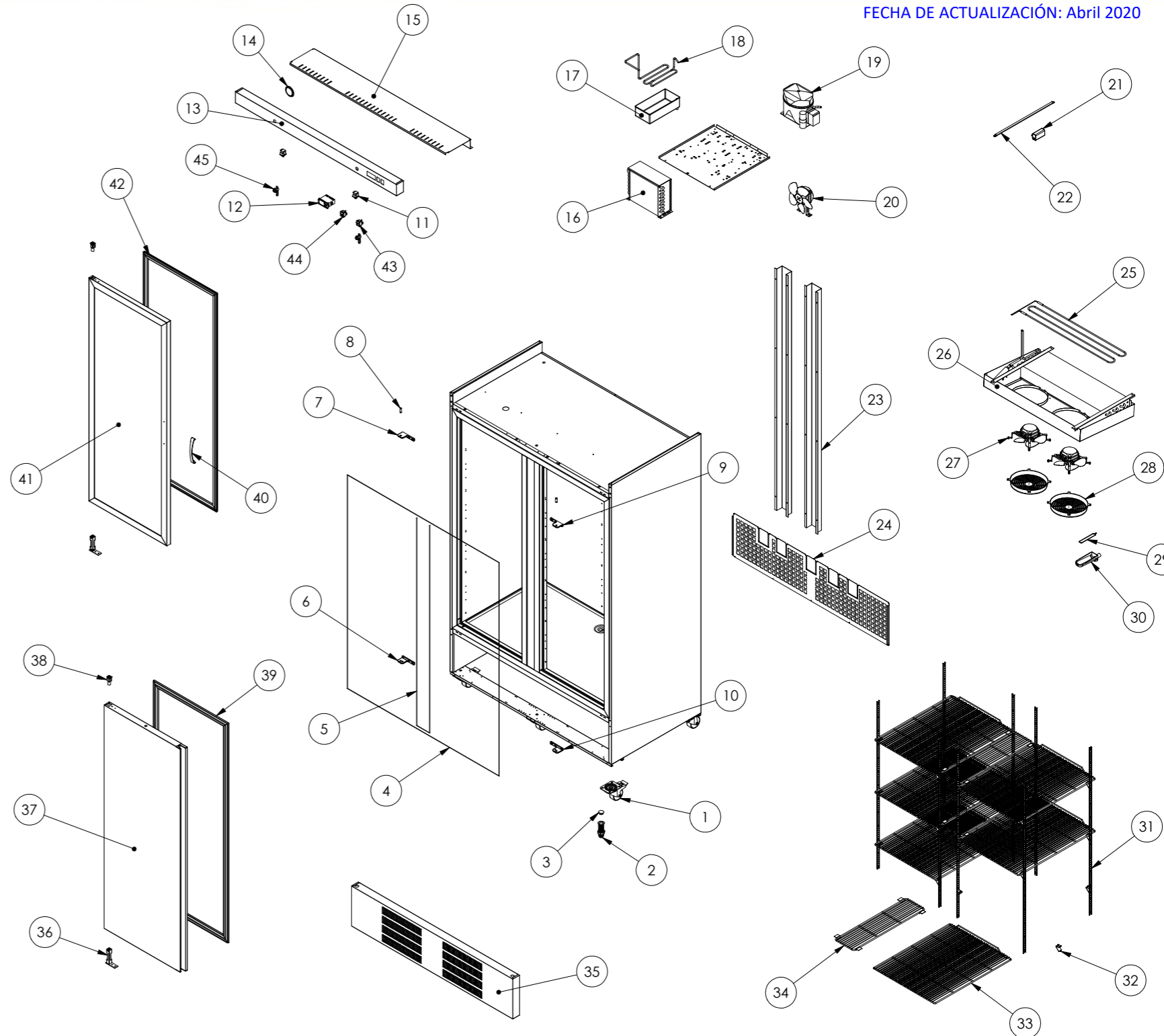

| Nº | DESCRIPCIÓN | DESCRIPTION | UPR-55*    | UPL-55**   |
|----|-------------|-------------|------------|------------|
| 16 | CONDENSADOR | CONDENSER   | 6029020003 | 6029020031 |
| 19 | COMPRESOR   | COMPRESSOR  | 6021010142 | 6021010175 |
| 26 | EVAPORADOR  | EVAPORATOR  | X          | 6029010197 |

\*Gas opcional R-134a (Optional gas R-134a)

\*\*Gas opcional R-449A (Optional gas R-449A)