



CORECO



INSTRUCTION MANUAL FOR S-LINE MODULAR REFRIGERATED ENCLOSURES

TABLE OF CONTENTS

1. RECEIPT OF THE CHAMBER

1.1 Observation

1.2 Checking

2. INSTALLATION INSTRUCTIONS CHAMBER WITH PANEL FLOOR

2.1 Before assembly

2.2 Start of assembly

1. RECEIPT OF THE CAMERA

1.1. Observation

- Before unpacking, ensure that the packaging has not been damaged or crushed during transport, which could have damaged the product.
- Never remove the panels by dragging them.



1.2. Checking

- The accessory box where you found this manual should contain the following items.



Name: Universal assembly key.

Use: Used to activate the eccentric mechanism that joins the panels together.

Supply: 1 unit per camera



Name: White plug for wall or ceiling panel. **Use:** Used to cover the entry holes of the mounting bracket.

Supply: 1 unit per hole.



Name: Grey or brown plug for floor panel. **Use:** Used to cover the entry holes of the mounting bracket.

Supply: 1 unit per hole.

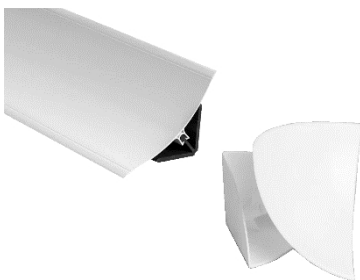

Name: Profile and sanitary joint.

Use: Used to finish the joints, on three planes, of the sanitary profile.

Profile supply: 1 unit per upper and lower corner of the chamber.

Joint supply: 1 unit for each corner of the chamber.



Name: Junction box.

Use: Used to make various electrical connections.

Supply: 1 unit per chamber.



Name: Pressure compensation valve. **Use:** Used to compensate for the pressure difference between the inside and outside.

Supply: 1 unit per freezer chamber or upon request.

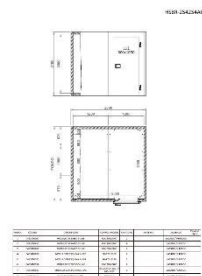

Name: Instruction manual and documentation. **Use:** Necessary to follow a logical assembly procedure. **Supply:** 1 instruction manual and documentation.



Name: Lighting.

Use: Used to illuminate the interior of the chamber.

Supply: 1 unit per chamber when no equipment is included.

2. ASSEMBLY INSTRUCTIONS FOR CHAMBER WITH FLOOR PANEL

2.1. Before assembly

2.1.1. Camera location

- Ensure that the floor where the chamber will be placed is perfectly level.
- The floor must be free of dirt and objects that could be accidentally left under the panels.
- Examine the final location of the cold room on the premises, paying special attention to the location of the door and ensuring that it can be opened without obstruction.
- Finally, check that there is sufficient space for the refrigeration equipment.



The door can be placed on either side of the chamber as long as there is a panel of the same width as the door panel.

2.1.2. Operation of the Eccentric Mechanism

Before starting to assemble the chamber, it is important that you understand the correct use of the assembly key and the operation of the eccentric mechanism of the connecting hooks.

- Operation of the assembly key:

The assembly key should always be inserted into the holes perpendicular to the panel. The assembly key should always be turned to the right (clockwise). When removing the mounting key, do so perpendicular to the panel.

- Operation of the eccentric mechanism of the connecting hooks:



Sometimes some hooks offer some resistance when picking up the eccentric. This is normal and is due to the process of mounting the eccentrics in the ABS casing. When this occurs, turn and pick up the eccentric from the hook without making any kind of connection, then return the hook to its initial position and this resistance will disappear.

1. INITIAL POSITION OF THE HOOK ON THE PANEL

THE HOOK IS OPEN

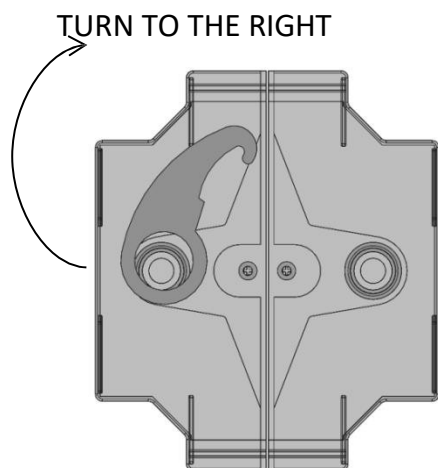

2. POSITION OF THE HOOK WHEN TOUCHING THE PIN OF THE ADJACENT PANEL

THE HOOK IS OPEN

TURN TO THE RIGHT

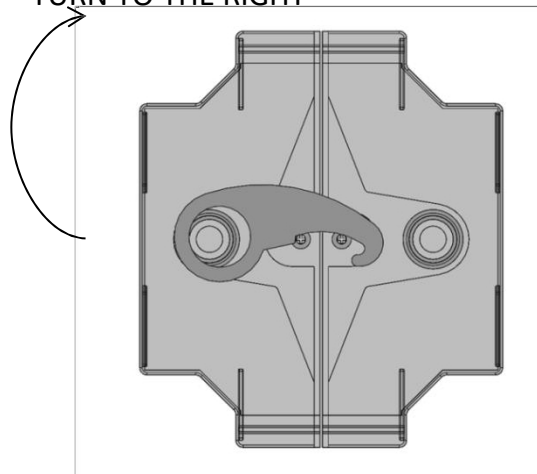

3. FINAL POSITION OF THE HOOK (PANELS JOINED)

THE HOOK IS CLOSED

TURN TO THE RIGHT

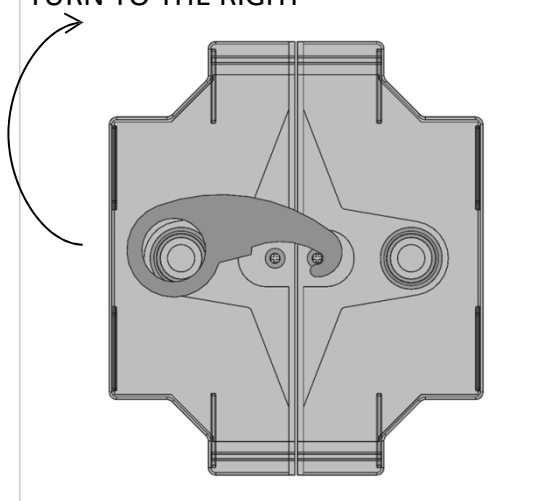

4. FINAL POSITION OF THE HOOK WHEN DISCONNECTING THE PANELS

THE HOOK IS OPEN

TURN LEFT

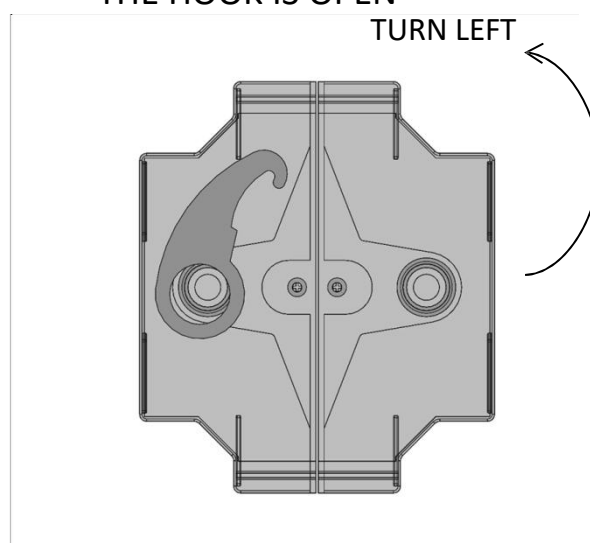

2.1.3. Identification of the panels

To facilitate assembly, the panels are clearly identified with coloured stickers. Each colour identifies a type of panel:

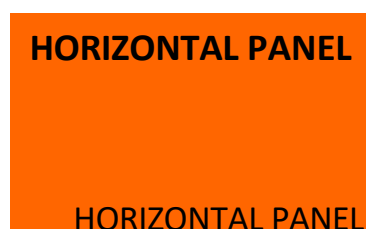
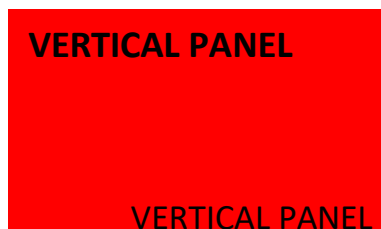

2.2. Start of assembly

Step 1.

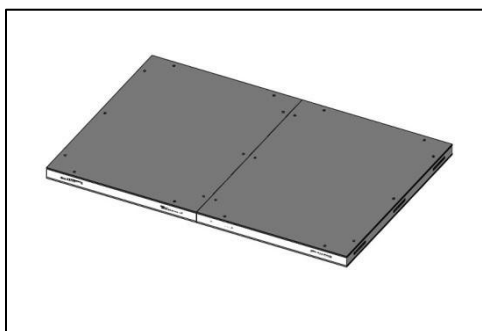

Place the floor panels according to the layout shown in the attached plan and join them together using the hook.

Some floor panels have a specific orientation, so care must be taken to ensure that the hook casings are correctly aligned.

View assembly plan.

Step 2.

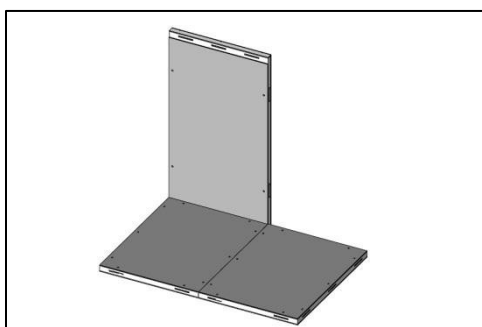

Carefully consider which vertical panel to start the assembly with, depending on the layout of the room where the chamber will be installed. We recommend that the side where the door is located be the last to be assembled.

Place the first vertical panel (NOT THE CORNER PANEL) in line with the floor panel. Do not tighten the eccentric mechanisms until they are perfectly aligned.

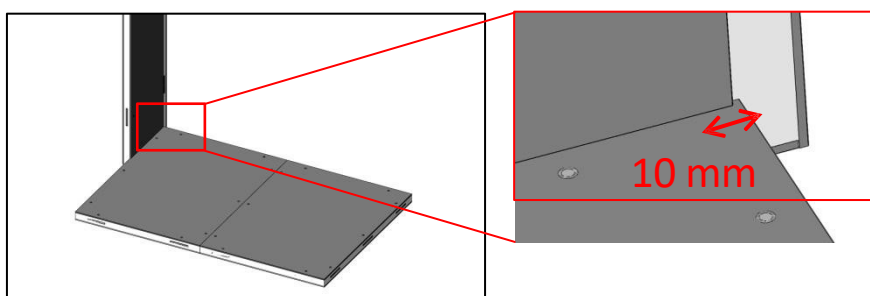

If the first vertical panel you place is a corner panel, it should be 10 mm off-centre from the floor panel.

Step 3.

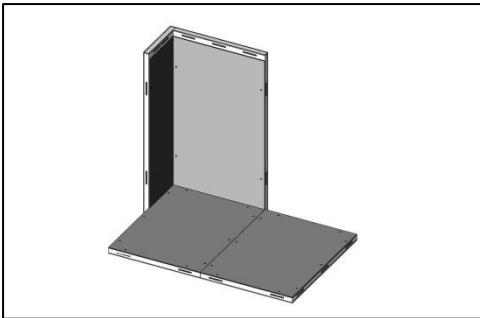

Place the vertical panel that forms the corner with the first panel in place. As mentioned above, do not tighten the eccentric mechanisms until the vertical panel is perfectly aligned with the rest of the panels.



The eccentric mechanism of the hook is always operated in a clockwise direction.

Step 4.

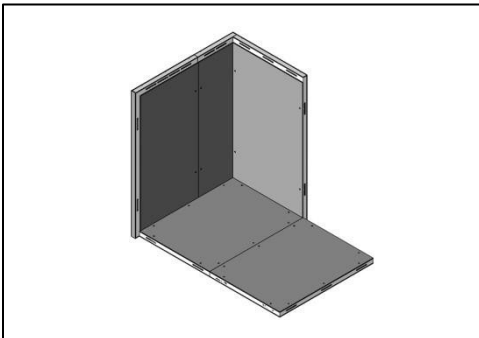

Next, place all the panels on that side.

Remember: It is advisable to assemble the side closest to a wall to facilitate the assembly of the other sides. Always cover the length of the floor panel.

Step 5.

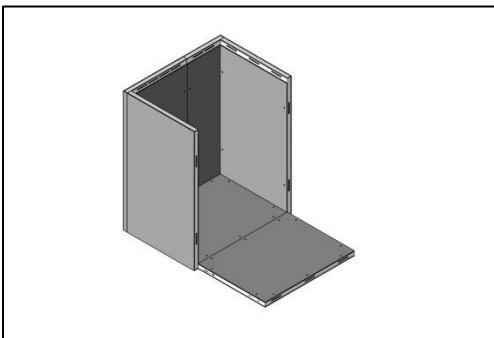

In the same order as for the first side wall, assemble the front wall as shown in the image, leaving 3 supports for the ceiling (step 6).



The eccentric drive of the hook always operates in a clockwise direction.

Step 6.

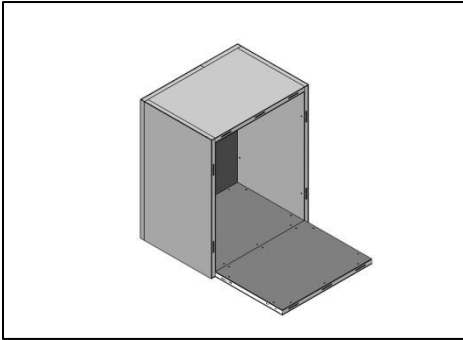

Next, place a ceiling panel to complete the first "ring" of the chamber.

Step 7.

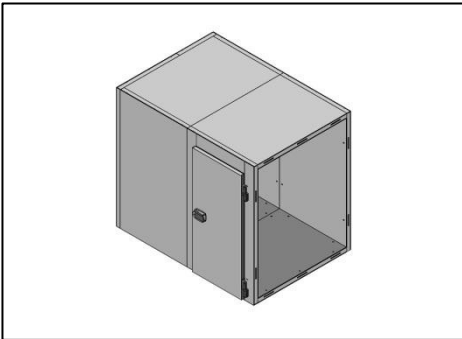

Finish assembling all the remaining "rings" until the last side of the chamber is left to be assembled.

*Whenever possible, place the "ring" containing the door wall panel as the last one. **(STEP 9)***

Step 8.

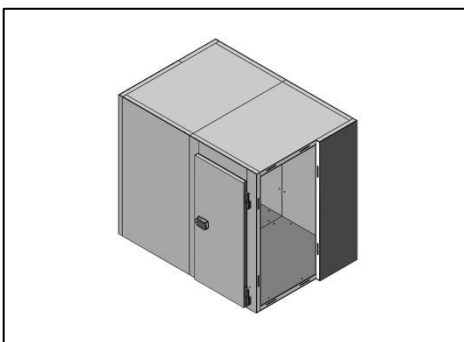

Place the last side of the chamber, ensuring that all hooks are correctly closed and panels are level.



The hook's eccentric mechanism is always operated in a clockwise direction.

Step 9.

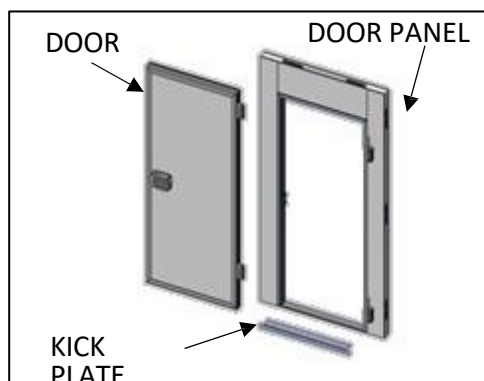

Remove the door before installing the door panel. The door panel is installed in the same way as any other wall panel. Once the door panel is in place, attach the kick plate to the bottom of the door panel.

Replace the door on the hinge and check that it closes properly. Check that the weatherstripping fits correctly on the door frame and that no light enters the interior of the chamber.



If light comes through, move the hinge pins to adjust the door correctly to the frame.

Step 10.

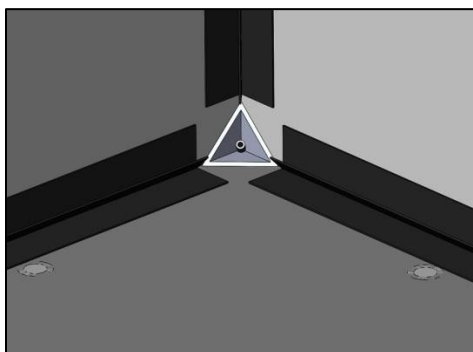

Place the sanitary radius profile bars in the corners of the chamber, leaving a 35 mm gap from the side so that the connecting joint can be fitted later. First, place the L-shaped profile and then clip on the sanitary radius profile.

Step 11

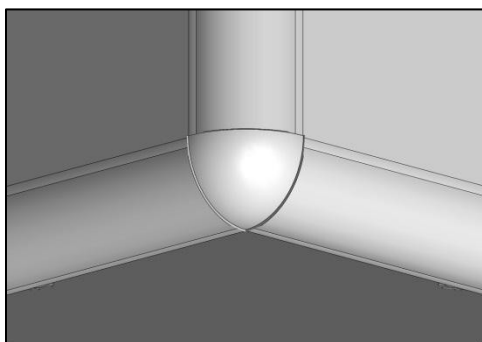

Place the sanitary joint in the corner of the chamber to give a better finish on the inside.



Remove the protective film from the sheet metal on all panels, both inside and outside.



CORECO S.A.

Ctra. Córdoba-Málaga Km.80,800 14900

Lucena (Córdoba)

Tel. 957 50 22 75 (5 lines)

Fax: 957 51 42 98